

BEARINGS ARE PER THE CENTERLINE BEARING OF RIVER ROAD (N80°14'00"E) PER DEED RECORDED IN DOC#2009R016629 OF THE LAKE COUNTY DEED RECORDS AND ARE USED TO DENOTE ANGLES ONLY.

LEGEND
 ● = IRON PIPE FOUND
 ⊙ = IRON PIN SET

ALL IRON PINS SET ARE 3/8" x 30" REBAR CAPPED AZTECH #8249

REFERENCES:
 BOUNDARY SURVEY FOR 3558 RIVER ROAD BY MASTEN & ASSOCIATES, INC. DATED: DECEMBER 2004
 SURVEY FOR ROBERT CASE BY J.M. GRABBS C.E. DATED: MAY, 1941

ZONING:
 CURRENT ZONING: ER-3
 MINIMUM LOT AREA: 3 ACRES
 MINIMUM FRONTAGE:
 AT RIGHT-OF-WAY: 200 FEET
 FOR REAR LOTS: 60 FEET
 MINIMUM FRONT SETBACK: 50 FEET
 MINIMUM LOT WIDTH @ BUILDING LINE: 200 FEET
 MINIMUM SIDE YARD: 15 FEET
 MINIMUM REAR YARD: 15 FEET

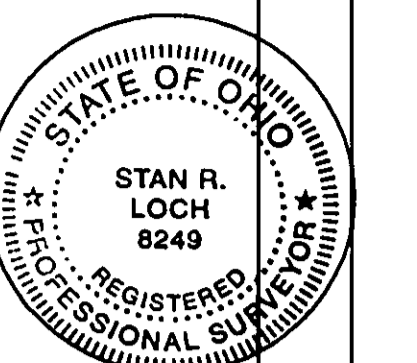
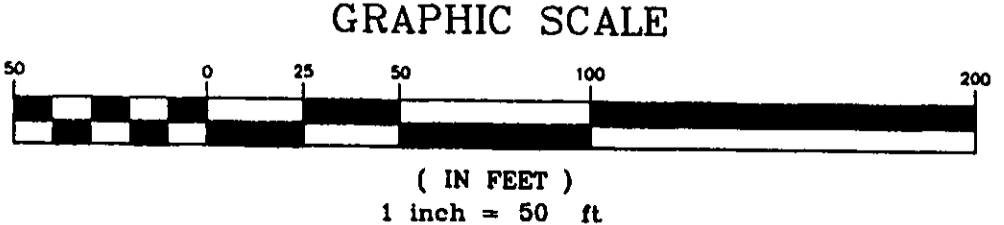

I CERTIFY THAT I HAVE SURVEYED THE PREMISES AND PREPARED THE SURVEY MAP IN ACCORDANCE WITH THE PROVISIONS OF CHAPTER 4733-37 OF THE OHIO ADMINISTRATIVE CODE.
 STAN LOCH DATE 6-9-10
 REG SURVEYOR #8249

5425 WARNER ROAD - SUITE 12
 VALLEY VIEW, OHIO 44125
 440-602-9071

AZTECH
 FAX 216-369-0259
 ENGINEERING and SURVEYING
 Civil Engineering · Land Surveying

SHEET CONTENT
 LOT SPLIT SURVEY
 FOR
 CLEMENS & MARY
 GUENTHER
 PP#03-A-023-0-00-001-0
 DOC#2009R016629
 BEING PART OF
 ORIGINAL LOTS 17 & 27
 SITUATED IN THE
 TOWNSHIP OF PERRY
 COUNTY OF LAKE
 STATE OF OHIO

NO.	DATE	DESCRIPTION	BY
1	6/8/10	REVISED PER COUNTY	CL

HORIZ. SCALE		VERT. SCALE	
1" = 50'			
DRAWN BY	CL	DATE	6/2/10
CHECKED BY	SRL	DRAWING NO	SURVEY
JOB NO	20102328	SHEET	1 OF 1