

**RESURVEY & COMBINATION OF LANDS**  
 ALL THAT CERTAIN LANDS SITUATE IN LOTS 103 & 113, VILLAGE OF NORTH PERRY, TOWNSHIP NUMBER 11 NORTH, RANGE VII WEST, IN THE CONNECTCUT WESTERN RESERVE SURVEY, COUNTY OF LAKE, STATE OF OHIO. A RESURVEY & COMBINATION OF THE LANDS TO GERTRUDE LOSELY, TRUSTEE, AS RECORDED IN DOCUMENT NUMBER 2017R021719 (PPN 05-A-012-0-00-005-0, PPN 05-A-012-0-00-009-0, PPN 05-A-012-0-00-017-0, PPN 05-A-013-0-00-013-0 & PPN 05-A-013-0-00-014-0) IN THE OFFICE OF THE COUNTY RECORDER.

SEE PAGE 2 OF 2 FOR LINE TABLE AND ADJOINING PROPERTY OWNER INFORMATION

**NOTES & REFERENCES**

- ALL IRON PIN SET ARE 5/8" X 30" REBAR WITH CAP "CRABBS 7245".
- DEEDS OF RECORD
- SURVEY BY CRABBS' SURVEYING SERVICE FOR CHAS PFEFFERKORN & THOMAS CHILDS, DATED 1923
- OCCUPATION AGREES WITH TITLE LINES AS PREVIOUSLY MONUMENTED EXCEPT AS SHOWN ON THIS PLAT

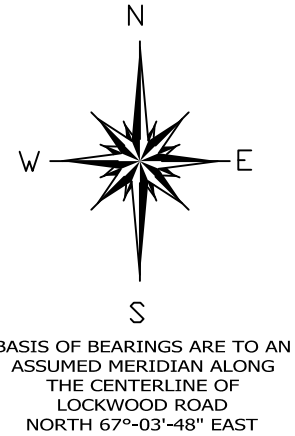

THIS SURVEY WAS PERFORMED TO AN ACCURACY AS SET FORTH IN THE 2003 OHIO ADMINISTRATIVE CODE 4733-37.



SCALE: 1" = 500'  
 SURVEY: SEPTEMBER 7, 2017  
 MAP: SEPTEMBER 23, 2017

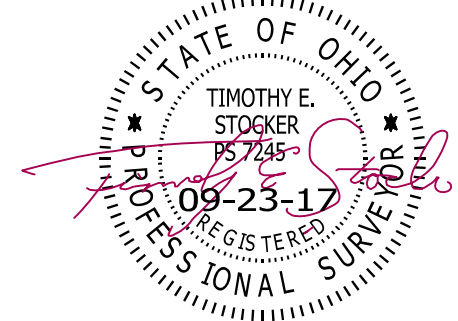

TIMOTHY E. STOCKER, P.S. 7245

PREPARED FOR:  GERTRUDE LOSELY, TRUSTEE	PROJECT NAME: RESURVEY & COMBINATION OF LANDS	PROJECT ADDRESS: LOCWOOD ROAD PERRY, OHIO
	PROJECT LOCATION: LAKE COUNTY, OHIO	JOB NUMBER: 6840
<b>FOR INQUIRIES CONCERNING THIS SURVEY CONTACT:</b>  <b>CSS</b> CRABBS' SURVEYING SERVICE P.O. BOX 908 PAINESVILLE, OHIO 44077 1-800-488-3968		CHK: T. STOCKER DRN: S. HUPERTZ REV:
		PAGE 1 OF 2