

This survey is a boundary survey prepared in accordance with Chapter 4733-37, Ohio Administrative Code. The basis of bearings for this survey is North 88°-18'-00" West as the northerly line of Shamrock Drive (formerly Orchard Street), as evidenced by monuments found, and is the same bearing as found in Volume C of Maps, Page 34 of Lake County Records. Distances are given in feet and decimal parts thereof. All iron pins shown as set are 30" long 5/8" rebar with an identification cap stamped "McSTEEN 7104".

MAP OF SURVEY FOR 7375 SHAMROCK DRIVE

Known as being part of Sublot Nos. 97, 98 and 99 in the Fourth Salida Subdivision of part of Original Mentor Township Lot No. 3, Tract No. 16, as shown by the recorded plat in Volume C of Maps, Page 34 of Lake County Records, now situated in the

**CITY OF MENTOR ON THE LAKE
COUNTY OF LAKE - STATE OF OHIO**

by
McSTEEN & ASSOCIATES, INC.

ENGINEERS & SURVEYORS

1415 East 286th Street
Wickliffe, Ohio 44092
(440) 585-9800

**SUBJECT
PROPERTY OWNERSHIP**
PPN 19A-089-H-00-030-0
JOANNE WILLIAMS
DOC. No. 2004R025664
L. C. R.

**SUBJECT
PROPERTY AREA**
23,635 SQUARE FEET
(0.543 ACRE)

NORTH

GRAPHIC SCALE



(IN FEET)
1 inch = 40 feet

Robert A. Dorner 9/01/09
ROBERT A. DORNER REG. PROF. SURV. No. 6943

Job No.: 09-160

Site No.: 2656

Field Date: August 27, 2009

Survey Date: August 31, 2009

F. B. 09-02, Pg. 1

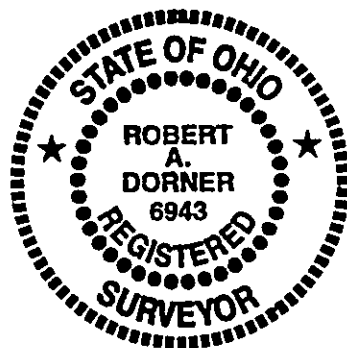

F:\Land Projects 2004\09-160\dwg\09-160.dwg 8/28/2009 1:53:27 PM EDT

