

EAST 300TH STREET - 60' RW

FRANK DRIVE -
50' RW

RESURVEY OF LANDS
ALL THAT CERTAIN LANDS SITUATE IN LOT 13, TRACT 11, CITY OF WICKLIFFE,
TOWNSHIP NUMBER 9 NORTH, RANGE X WEST, IN THE CONNECTICUT WESTERN
RESERVE SURVEY, COUNTY OF LAKE, STATE OF OHIO. A RESURVEY OF THE LANDS TO
CHASE HOME FINANCE, LLC, AS RECORDED IN DOCUMENT NUMBER 2004R030505 (PPN
29-B-005-E-00-021-0) IN THE OFFICE OF THE COUNTY RECORDER.

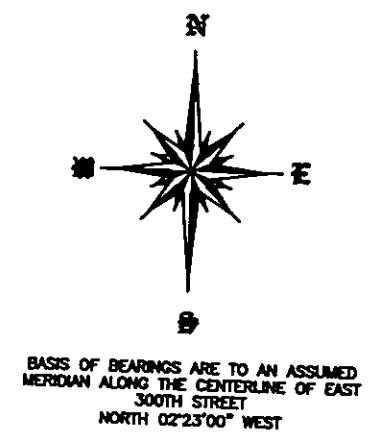

327.38' OBS
S 02°23'00" E
46.67' OBS
N 02°23'00" W

POB

0.0321 AC
IN RW

P.F. BERIS
DOC. 2005R026873
PPN 29-B-005-E-00-022-0

N 89°55'31" E
234.28' DEED OBS

0.2496 ACRES
CHASE HOME FINANCE, LLC
DOC. 2004R030505
PPN 29-B-005-E-00-021-0

232.14' OBS - 232.20' DEED
S 89°55'02" W

V.E. HENRY
DOC. 2004R040002
PPN 29-B-005-E-00-020-0

5/8" IRON PIN
FOUND & USED

46.60' DEED OBS
S 00°14'37" W

CITY OF WICKLIFFE
VOL. 625, PG. 11
PPN 29-B-005-E-00-024-0

THIS SURVEY WAS PERFORMED TO AN
ACCURACY AS SET FORTH IN THE 2003
OHIO ADMINISTRATIVE CODE 4733-37.

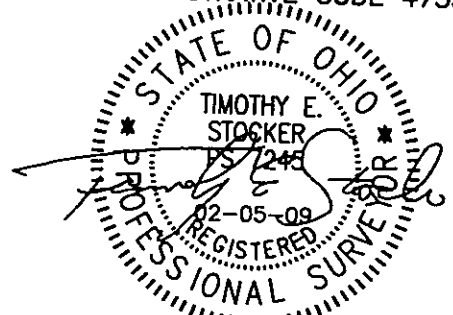

TIMOTHY E. STOCKER, P.S. 7245

LEGEND

- 5/8" IRON PIN FOUND/SET
- ⊙ IRON PIPE
- STONE MONUMENT
- ⊠ MONUMENT BOX
- ⊙ P.K. NAIL FOUND/SET
- DRILL HOLE FOUND
- CALC CALCULATED
- MEAS MEASURED
- OBS OBSERVED
- DEED DEED RECITED
- PLAT PLAT RECITED

REFERENCES

- DEEDS OF RECORD
- CRABBS' SUREYING -
SURVEY FOR THE BAKER
ESTATE - JULY 7, 1941

ALL IRON PIN SET ARE 5/8" X 30"
REBAR WITH CAP "CRABBS 7245".

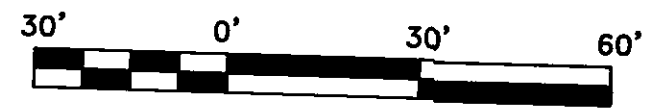

SCALE: 1" = 30'
FEBRUARY 3, 2009
REVISED FEBRUARY 5, 2009

PREPARED FOR: - CHASE HOME FINANCE, LLC -	PROJECT NAME: RESURVEY OF LANDS	PROJECT ADDRESS: 1823 EAST 300TH STREET WICKLIFFE, OH
	PROJECT LOCATION: LAKE COUNTY, OHIO	JOB NUMBER: 4660
FOR INQUIRIES CONCERNING THIS SURVEY CONTACT: CSS CRABBS' SURVEYING SERVICE P.O. BOX 908 PAINESVILLE, OHIO 44077 1-800-488-3968		CHK: T. STOCKER DRN: S. LOVEJOY REV: PAGE 1 OF 1