

LEGEND
 ○ = IRON PIN FND
 □ = MONUMENT BOX
 ⊙ = 5/8" x 30" IP SET CAPPED "AZTECH #B249"

REFERENCES
 1. COUNTY TAX MAPS
 2. PINE VALLEY SUBDIVISION PLAT VOLUME 48, PAGE 17

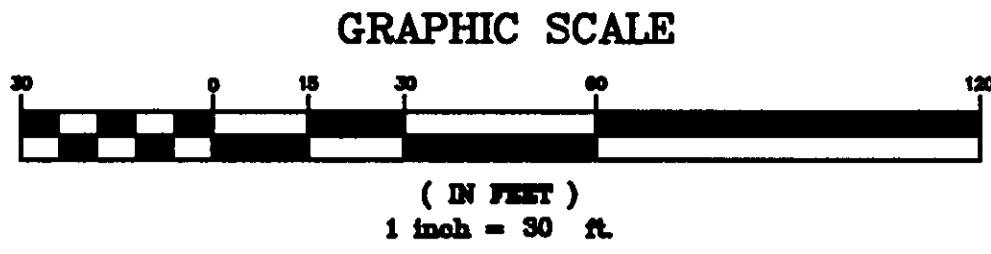

BEARINGS ARE PER THE CENTERLINE BEARING OF PINE VALLEY DRIVE (S50°08'48"W) PER THE PINE VALLEY SUBDIVISION PLAT AS RECORDED IN PLAT VOLUME 48, PAGE 17 AND ARE USED TO DENOTE ANGLES ONLY.
 ALL IRON PINS SET ARE 5/8" x 30" REBAR CAPPED AZTECH #B249

NOTES
 MONUMENT BOXES AND IRON PINS TO BE SET INSIDE MONUMENT BOXES WILL BE INSTALLED AFTER ROAD CONSTRUCTION IS COMPLETE.

STATE OF OHIO
 VOLUME 494, PAGE 255

SUBLOT 30
 FERRINO CUSTOM HOMES
 P.P.#31-A-017-D-00-030-0
 DOC.#2005R026087

SUBLOT 31
 MAPLEGROVE DEVELOPMENT CO., LLC
 P.P.#31-A-017-D-00-031-0
 VOLUME 48, PAGE 17

SUBLOT 32
 MAPLEGROVE DEVELOPMENT CO., LLC
 P.P.#31-A-017-D-00-032-0
 VOLUME 48, PAGE 17

SUBLOT 33
 MAPLEGROVE DEVELOPMENT CO., LLC
 P.P.#31-A-017-D-00-033-0
 VOLUME 48, PAGE 17

OVERALL
 87,890 SQ.FT.
 2.0176 ACRES

P.O.B.
 PK NAIL FND (IP SET IN MON BOX AFTER ROAD CONSTRUCTION IS COMPLETE)
 MICHELLE COURT
 60' R/W

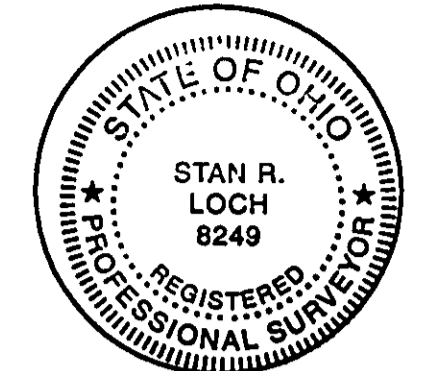

I CERTIFY THAT I HAVE SURVEYED THE PREMISES AND PREPARED THE SURVEY MAP IN ACCORDANCE WITH THE PROVISIONS OF CHAPTER 4733-37 OF THE OHIO ADMINISTRATIVE CODE.

STAN R. LOCH
 DATE 1-9-09
 REG SURVEYOR #8249

38878 MENTOR AVENUE SUITE A
 WILLOUGHBY OHIO 44094
 440-602-9071



ENGINEERING and SURVEYING
 CMI Engineering - Land Surveying

SHEET CONTENT

LOT CONSOLIDATION SURVEY FOR MAPLEGROVE DEVELOPMENT CO. LLC. SUBLOTS 31 & 32 OF THE PINE VALLEY SUBDIVISION PLAT VOLUME 48, PAGE 17 PART OF ORIGINAL LOT 7, TRACT 10 SITUATED IN THE CITY OF WILLOUGHBY HILLS COUNTY OF LAKE STATE OF OHIO

REVISIONS

NO.	DATE	DESCRIPTION	BY

HORIZ. SCALE	VERT. SCALE
1" = 30'	
DRAWN BY KRG	DATE 1-9-2009
CHECKED BY SRL	DRAWING NO. SITEPLANS
JOB NO. 121345-SP	SHEET 1 OF 1

INTERSTATE 90 LAK-1-2.16

STATE OF OHIO
 VOLUME 494, PAGE 513

N50°03'55"E 210.00' PLAT & USED
 105.00' PLAT & USED

5/8" IP FND & USED CAPPED "AZTECH #B249"

S39°50'12"E 418.71' PLAT & USED

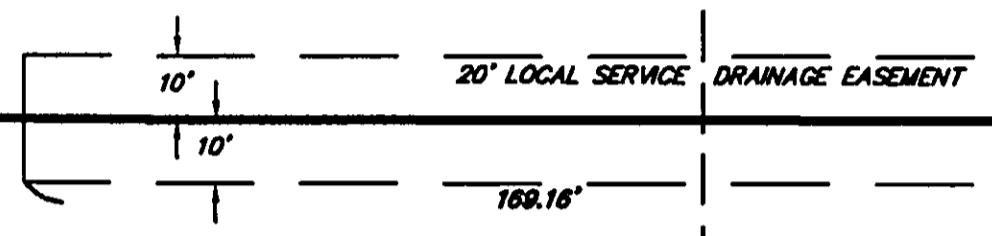

P.P.O.B.

5/8" IP SET CAPPED "AZTECH #B249"
 30.00' PLAT & USED

12' UNDERGROUND UTILITY EASEMENT

117.25' OBS. & USED

12' UNDERGROUND UTILITY EASEMENT

105.00' PLAT & USED

210.00' PLAT & USED

S50°09'48"W 544.50' PLAT & USED

PINE VALLEY DRIVE 60' R/W

5/8" IP SET CAPPED "AZTECH #B249"

N39°50'12"W 418.35' PLAT & USED

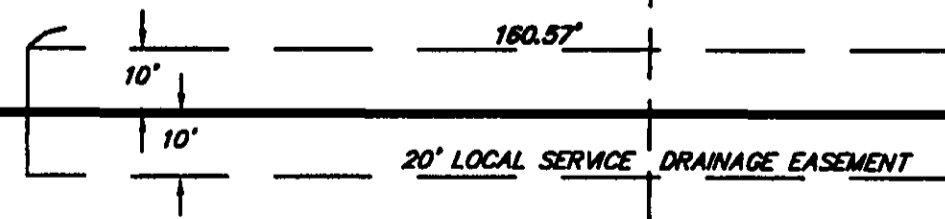

5/8" IP SET CAPPED "AZTECH #B249"

12' UNDERGROUND UTILITY EASEMENT

75' SETBACK LINE

PK NAIL FND (IP SET IN MON BOX AFTER ROAD CONSTRUCTION IS COMPLETE)