

Lake County GIS Department
LakeNavigator 3.0 Help - Search Tool

Description: This tool located in the upper left corner of the map window allows users to quickly search for a parcel using a few different criteria: PIN (parcel number), owner name, or address.

Function: To use the tool, simply enter a parcel number (with or without dashes), an owner's name, or an address directly in the box. As you enter the text, options will be presented for you to choose from. For addresses and names, adding less information will result in more choices. So, for example, it may be better to enter '105 main st' rather than '105 main street'.

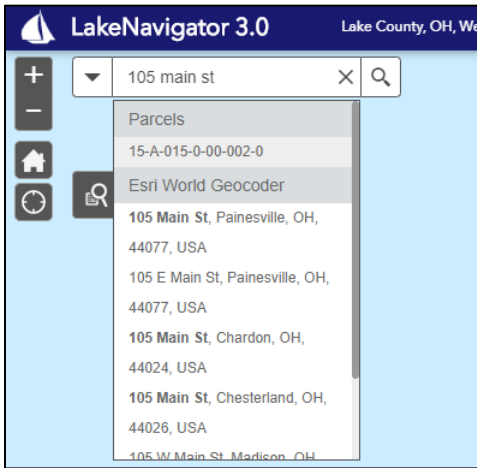

Clicking on the parcel number that comes up below the search box will zoom you to the parcel and bring up the popup information, including PIN, Owner Name, Address, Acreage, Documents, and links to other associated records.

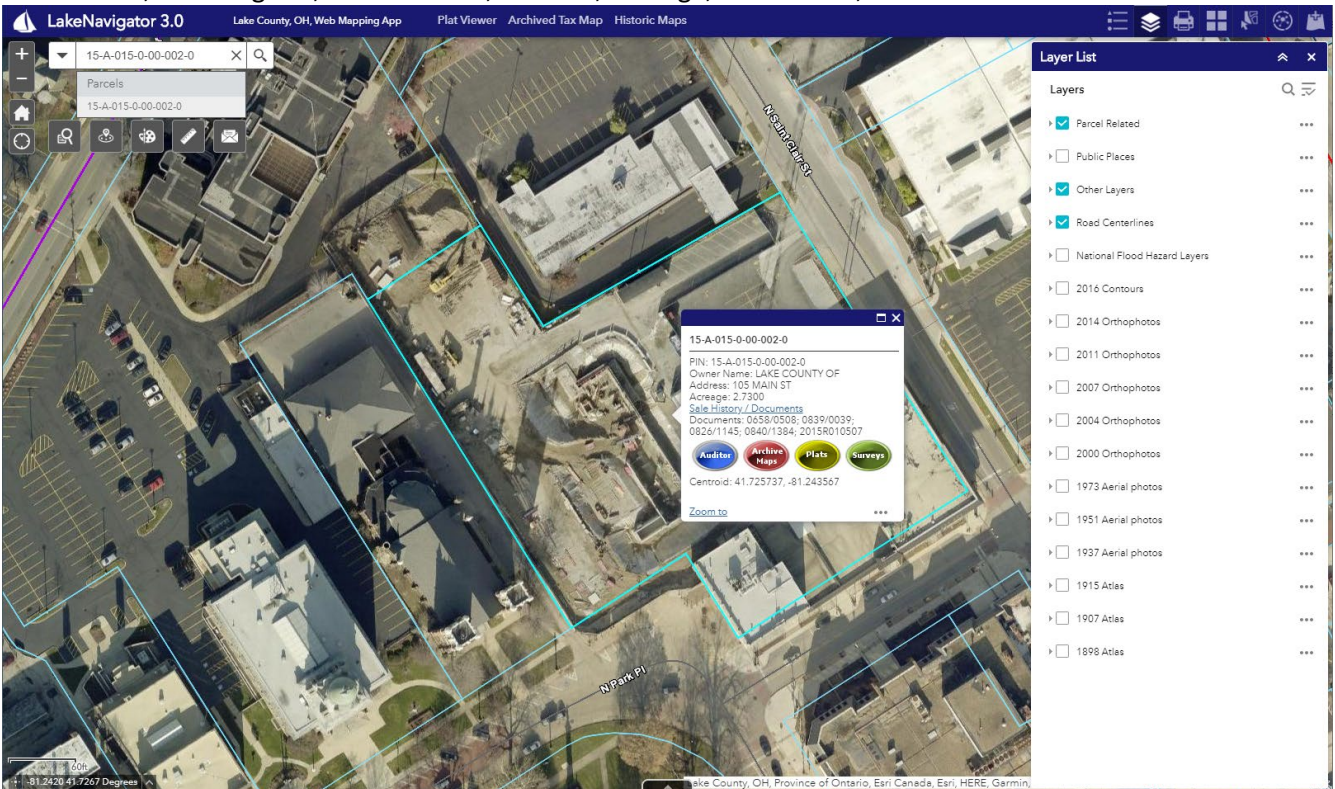

To get more help with this tool, see ESRI's help page for the 'Search' widget: https://doc.arcgis.com/en/web-appbuilder/create-apps/widget-search.htm#ESRI_SECTION1_A5706BF472D643F28B19B51A5CC6BDA9